



The Hayward is a fabulous four bedroom detached home with an integral garage.

The ground floor of the property benefits from a spacious family living room, a large open plan kitchen/diner, with French doors onto the garden, a utility room and a downstairs w/c.

The kitchen comes equipped with a quality Bosch oven, gas hob and extractor, with space for a washing machine, dishwasher and larder style fridge/freezer.

The first floor features a family bathroom, and four bedrooms - the master bedroom having an ensuite.

The lounge and bedrooms are carpeted in neutral tones, with wood effect ceramic tiles to the hall, kitchen/diner, and cloak room. The family bathroom and ensuite come complete with oak effect vinyl.

Plots 1, 24-26 all with garage

Total Area = 109m²

Ground Floor

Kitchen/Dining

4.95m x 2.79m

Utility

2.97m x 1.15m

Living

4.96m x 3.33m

First Floor

Bedroom 1

4.49m x 3.33m

Bedroom 3

2.89m x 2.76m

Bedroom 2

3.79m x 3.14m

Bedroom 4

2.89m x 2.37m

Ground Floor

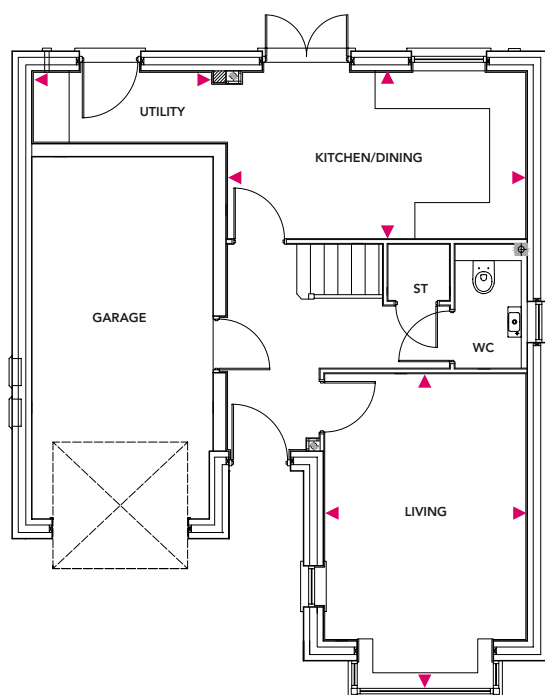

First Floor

