



The Hayward is a fabulous four bedroom detached home with an integral garage.

The ground floor of the property benefits from generous family living room, a large open plan kitchen/diner, with French doors onto the garden, a utility room and a downstairs w/c.

The kitchen comes equipped with a high quality Bosch double oven, gas hob and extractor, with space for a washing machine, dishwasher and fridge/freezer.

The first floor features a large family bathroom, and four bedrooms - the master bedroom having an ensuite.

The lounge and bedrooms are carpeted in neutral tones, with wood effect ceramic tiles to the hall, kitchen/diner, cloak room and vinyl to the family bathroom and ensuite.

**Plots 35, 36, 44 all with garage**

**Total Area = 108m<sup>2</sup>**

## Ground Floor

**Kitchen/Dining**  
4.91m x 2.76m

**Utility**  
3.09m x 1.14m

**Living**  
4.97m x 3.33m

## First Floor

**Bedroom 1**  
4.49m x 3.34m

**Bedroom 3**  
2.89m x 2.76m

**Bedroom 2**  
3.79m x 3.14m

**Bedroom 4**  
3.14m x 2.37m

## Ground Floor

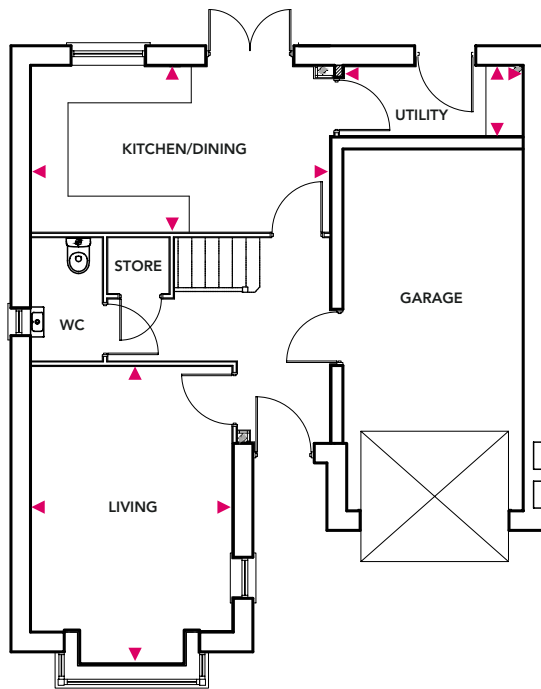

## First Floor

